

Uplift lbs	
Clip on One Face	Clip on Both Face
230	545

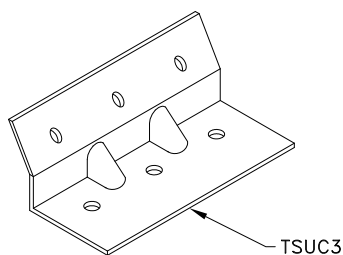
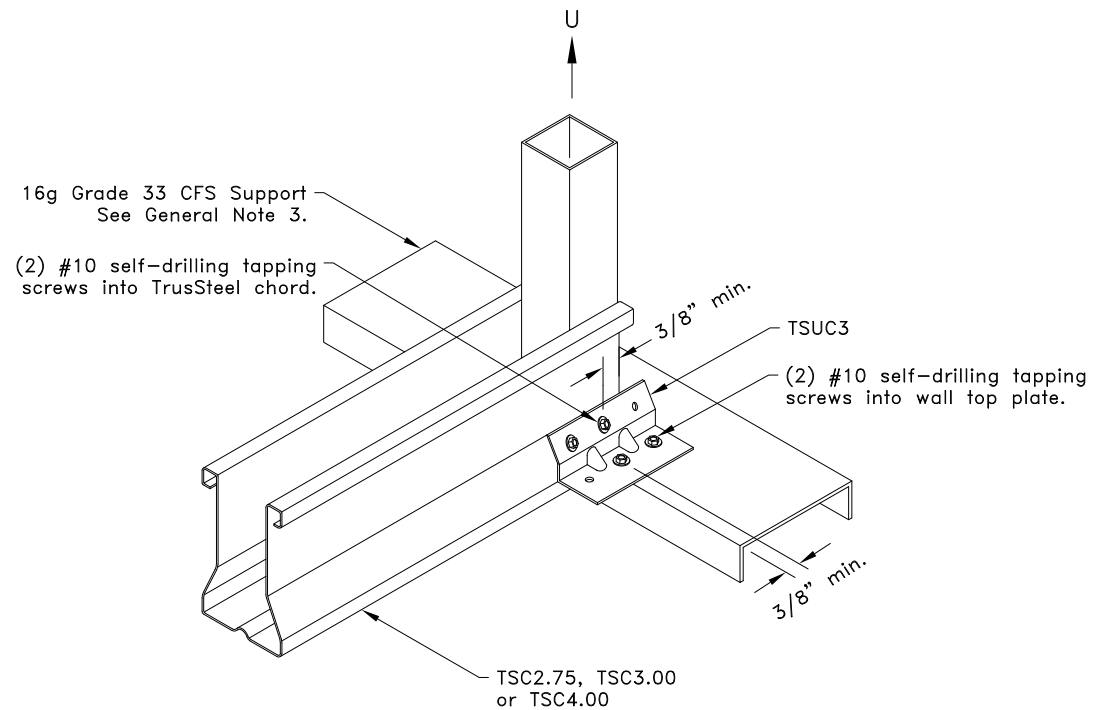

General Notes:

1. If a clip is required on both faces, attach the second clip to the opposite face of the chord as detailed.
2. Connection of top plate to wall stud must be capable of transferring truss uplift load from wall top plate to wall stud.
3. The wall top plate is to be designed by the job engineer. The wall top plate must be designed to support the loads applied to it (downward, upward and lateral).
4. U refers to Uplift.
5. Cold-Formed Steel Calculations are per the 2010 supplement to the AISI 2007 "North American Specifications for the Design of Cold-Formed Steel Structural Members" (S100-07/S2-10).

TrusSteel®

www.TrusSteel.com

Florida: 2400 Lake Orange Drive, Suite 150 / Orlando, FL 32837 / (800) 755-6001
Missouri: 13389 Lakefront Drive / Earth City, MO 63045 / (800) 326-4102

**TSUC3 Uplift Attachment To
Cold-Formed Steel**

ITW Building Components Group, Inc. shall not be responsible for any performance failure in a connection due to a deviation from this detail. Any variation from this detail shall be approved in advance by ITW Building Components Group, Inc.

Custom Detail:

CD140811

Date:

09/02/14

Custom Detail Category:

Truss-To-Bearing: Cold-Formed Steel